

Conveyor belt FBA46

Characteristics

The conveyor belts of type FBA46 make versatile applications possible. They are suitable both for transportation and hopper systems, as well as for buffer sections. Characteristic for the type FBA46 are its very robust design as well as the tailor-made conveyor belt lengths and widths. With the continuously adjustable motor, the belt speed



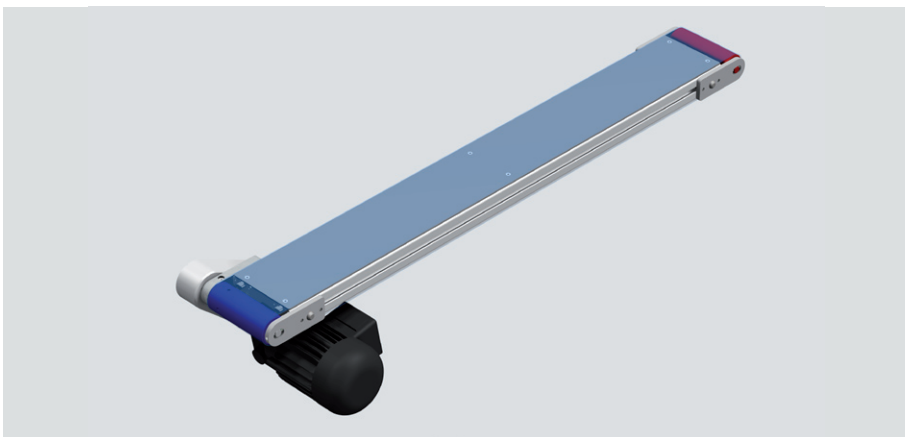

can be adapted to the work-specific conditions at any time.

can be adapted to the work-specific conditions at any time.

Structure



Color scheme of the individual components:

-  Drive roll
-  Deflector roll
-  Conveyor belt
-  Motor

Technical data

Device type	FBA46
Motor	230/400 V, 90 W, 50/60 Hz
Belt speed [m/min]*	0.7; 0.85; 1.14; 1.37; 1.71; 2.3; 2.74; 3.34; 4.11; 5.87; 8.22 and more
Belt type	PUR smooth, nylon-transilon, anti-slip, cleated belts, food-safe belts, chemical belts
min. belt width** [mm]	30
max. belt width** [mm]	400
min. belt length** [mm]	300
max. belt length** [mm]	3000
Protection class in accordance with DIN EN 60529	IP 54

* Continuous adjustment or other speeds available upon request.

** Special dimensions available upon request.

Dimensions

Device type	Dimensions [mm]	
	Width B*	Length L*
FBA46	30; 40; 50; 60; 80; 100; 120; 150; 160; 200; 250; 300; 400	500; 1000; 1500; 2000; 2500; 3000

Technical drawing

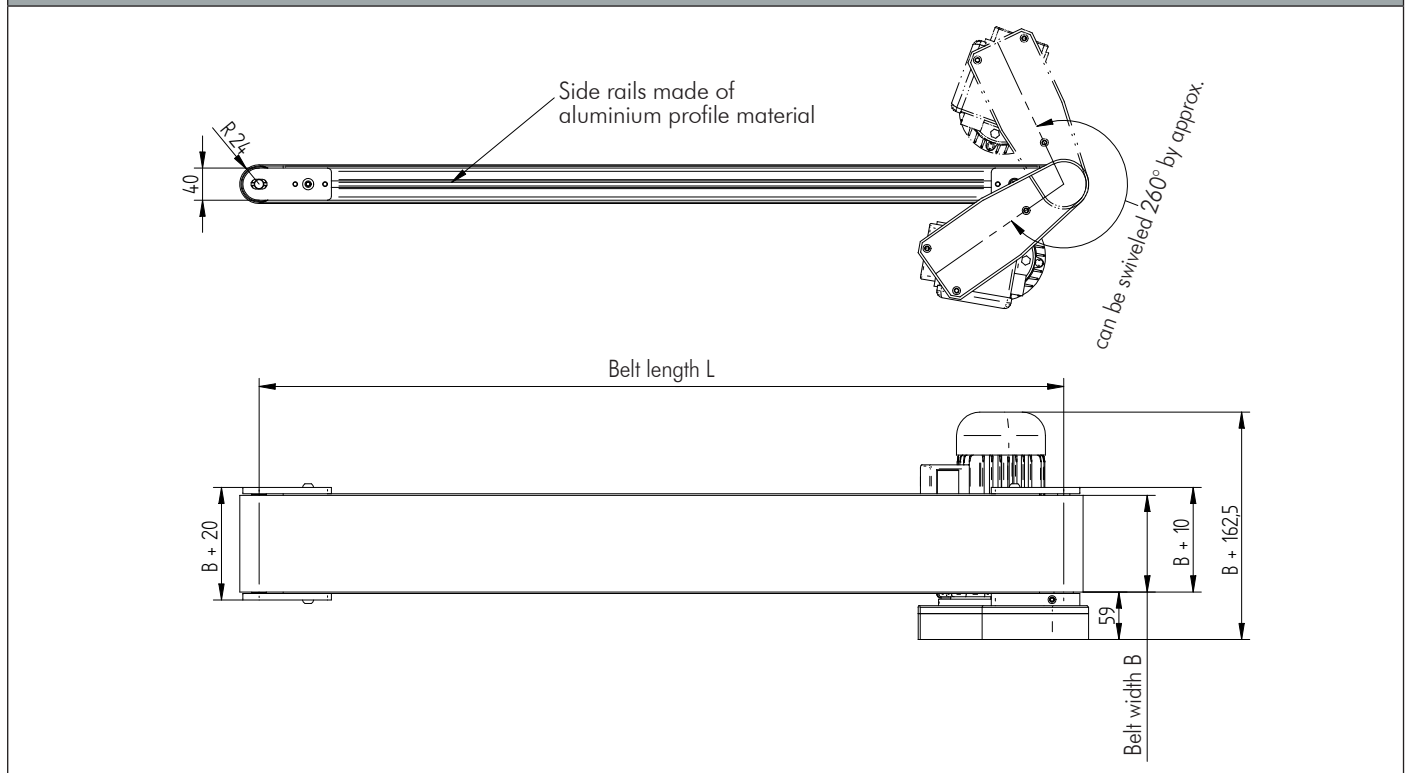

Accessories

Designation	Description	Article no.
Floor stand BS	Floor stand for optimum positioning of the conveyor belt	–
Belt type	PUR smooth, nylon-transilon, anti-slip, cleated belts, food-safe belts, chemical belts	–
Speed control DN21	Speed control DN21 for the continuous speed adjustment of 24 V DC motors, Adjustment of the conveyor belt speed, in 115V / 230V Ausführung lieferbar	2-009260
Drip tray	Drip tray for collecting and draining oil	–

* Special dimensions available upon request.