

# Step feeder SHF

## Characteristics

Thanks to its compact design, the Grimm step feeder requires little space and still offers a high accom-



modation volume for the material to be conveyed. This is usually made up of light to medium-heavy, large-

volume parts. Furthermore, Grimm guarantees that the workpieces are gently aligned with low noise.

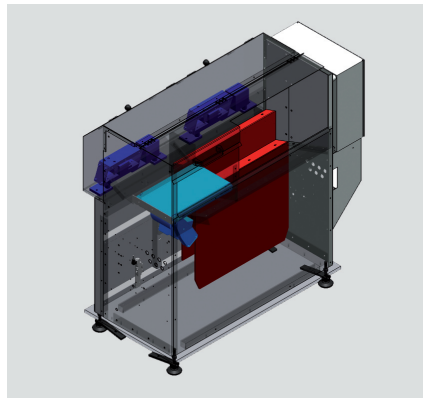
## Structure



Color scheme of the individual components:

-  Linear conveyor
-  Slide feed
-  Return belt

## Technical data

<b>Device type</b>	<b>SHF10-3-12</b>
<b>Mains voltage</b>	3 AC 400 V, 50/60 Hz
<b>Required mains power</b>	1 kVA
<b>Net weight [kg]</b>	approx. 500
<b>Filling weight [kg]*</b>	20-100
<b>Pneumatics</b>	5-6 bar
<b>Protection class in accordance with DIN EN 60529</b>	IP 54
<b>Article no.</b>	1-001372

\* Filling weight is part-dependent.

## Dimensions

Device type	Dimensions [mm]			
	Slide feed or filling width A	Length Y	Filling height H <sub>1</sub>	Feeding height H <sub>2</sub>
<b>SHF10-3-12</b>	approx. 700	1200	approx. 1030	approx. 1040 ± 50

### Technical drawing

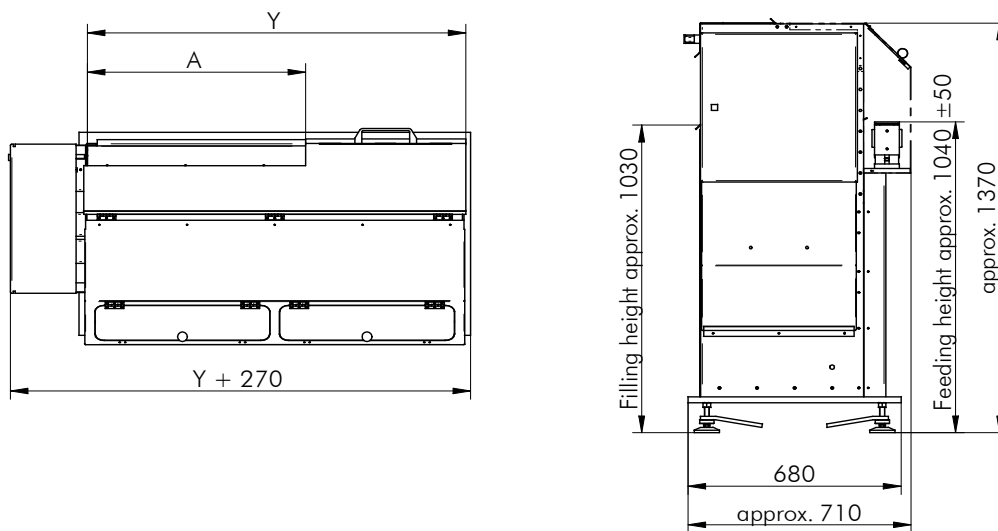

## Accessories

Designation	Description	Article no.
<b>Hopper belt BBH80-180</b>	Hopper belt for part stocking	1-000386
<b>Tilting device</b>	Tilting device for filling the hopper belt as well as for emptying wire mesh boxes	–