

Hopper system BBH

Characteristics

The hopper system of type BBH prolongs the autonomy of the feeding system decisively and also reduces its susceptibility to failure. It



is characterized by its space-saving structure, whereby filling weights of up to 500 kg can be transported. Combination options with pre- or

post-connected hopper systems as well as tilting devices for wire mesh boxes or large containers are possible.

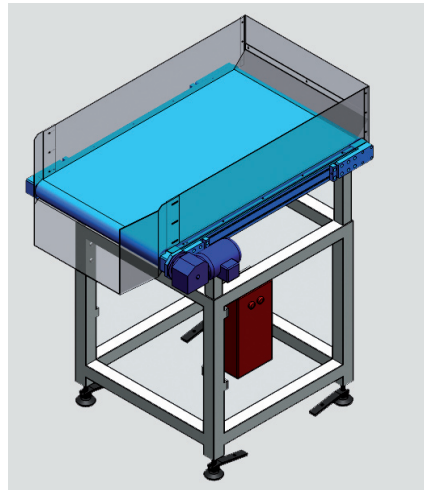
Structure



Color scheme of the individual components:

-  Motor
-  Hopper control
-  Conveyor belt

Technical data

Device type	BBH40-80	BBH80-180
max. filling volume [l]	80	180
max. filling weight [kg]	75	500
Protection class in accordance with DIN EN 60529	IP 54	IP 54
Article no.	1-001597	1-000386

Dimensions

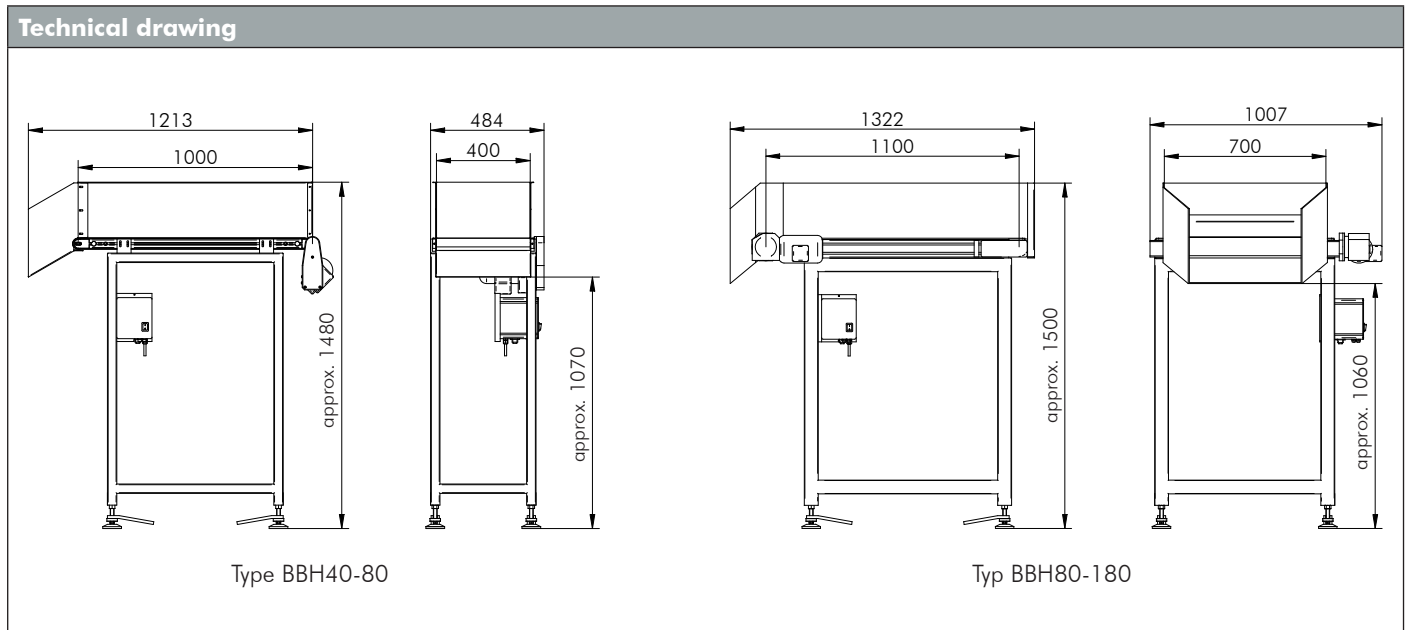

Accessories

Designation	Description	Article no.
Hopper control BS5	Hopper control BS5 for belt hopper of type BSF-1, BBH, BBR, BBV	2-009382
Pendulum switch PS1	Pendulum switch PS1 for automated filling level control of bulk material in the sorting device, compact design, optical status display via LED, inductive switch without wear	2-002099
Filling level query	Filling level query in the bulk hopper with light barrier divided into two parts	–
Container depot / platform	–	–